

Induktionsscheibe/wad

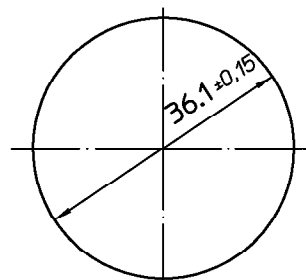

gauge dimension

Excerpt from DIN 16901 series 150

Postmolding ovality dimensions can be influenced by packaging and logistics
Nominal Diameters are defined as mean of two rectangular measurements

Dimension	0-3	3-6	6-10	10-15	15-22	22-30	30-40	40-53	53-70
Tolerance	±0,15	±0,17	±0,2	±0,24	±0,28	±0,33	±0,39	±0,47	±0,58



BERICAP
GmbH & Co.

D-55257 BUDENHEIM/RHEIN
Kirchstraße 5

Tel.: +49 (0) 6139/2902-0

Fax: +049 (0) 6139/2902-182

Prod-Hierarchy No.

Art.No.

PAR-00-0000137

Proj.No.

Sheet

X

X

Sh.

Dimension	0-3	3-6	6-10	10-15	15-22	22-30	30-40	40-53	53-70
Tolerance	±0,15	±0,17	±0,2	±0,24	±0,28	±0,33	±0,39	±0,47	±0,58

Tolerances unless
otherwise stated:
DIN 16 901 150

Surface:
DIN ISO 1302
(Ra)

This drawing is the property of Bericap Germany. It is confidential
and must not be copied or shown to third parties.

Drawn 28.02.2008
Approved 07.03.2008

Date Name
Tombarge
Tombarge

Title:

Screw cap
SK 38/23 S2 MIS Brasil 18-knurls

Scale:

1:1
(1:1)

metric
DIN A4

Category:

Customer drawing

Drawing No.:

ENG-00-019521 a

Repl.for:

K330642B